

## D-SUB. CONNECTOR CRIMP TYPE TERMINAL & HOUSING

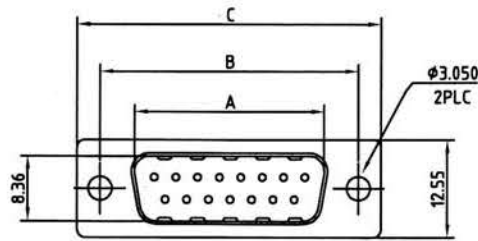

No. of Contacts	Dimensions(mm)			
	A	B	C	D
09	16.92	24.99	30.81	19.23
15	25.25	33.32	39.14	27.56
25	38.96	47.04	53.04	41.28
37	55.42	63.50	69.32	57.33

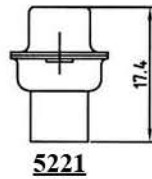
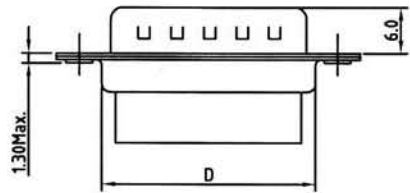

### SPECIFICATIONS

Current Rating: 3A

Contact Resistance: 25mΩ Max.

Insulation Resistance: 1000MΩ Min. at 500V

Dielectric Voltage: 1000V at 1 Minute

Operating Temperature: -55°C to +105°C

### MATERIALS

Insulator: PBT, UL94V-0 Rated

Contact: Brass

Shell: Brass, Steel

Contact Plating: Gold Over Nickel Plated

Shell Plating: Tin Over Copper Plated

\*RoHS & REACH compliant.

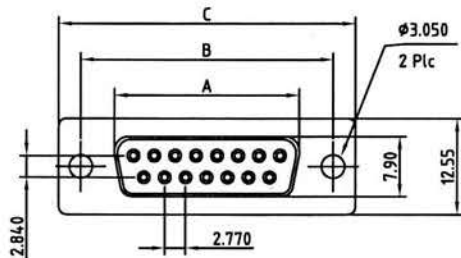

No. of Contacts	Dimensions(mm)			
	A	B	C	D
09	16.33	24.99	30.81	19.23
15	24.66	33.32	39.14	27.56
25	38.38	47.04	53.04	41.28
37	54.84	63.50	69.32	57.33

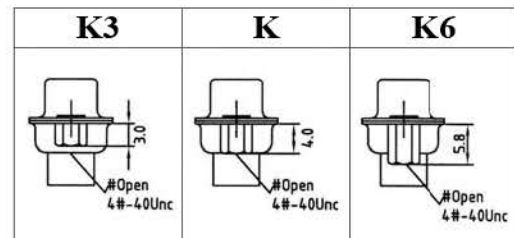
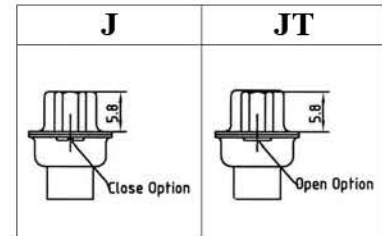
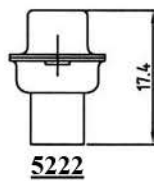
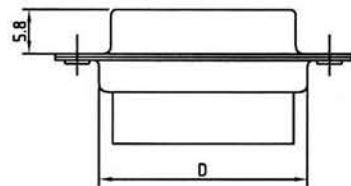

### ORDERING INFORMATION:

P/N 5 2  $\frac{XX}{1}$  -  $\frac{XX}{2}$  T B /  $\frac{XX}{3}$

#### 1. CONNECTOR TYPE:

"21" MALE  
"22" FEMALE

#### 2. NO. OF CONTACTS:

09, 15, 25, 37, 50

#### 3. MOUNTING OPTION:

" " Ø3.05MM THROUGH HOLES  
OTHERS: K, K3, K6, J, JT, J4

NOTE: CRIMPING TOOL P/N HT-213  
INSERTION & EXTRACTION  
TOOL P/N HT-101

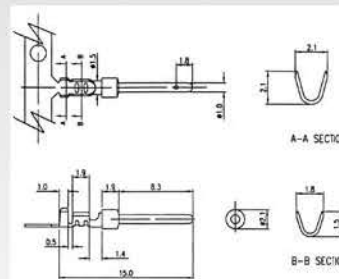

#### MALE TERMINAL:

5221-0.5K (500pcs/Reel)  
5221-10K (10000pcs/Reel)  
FOR AWG24-26

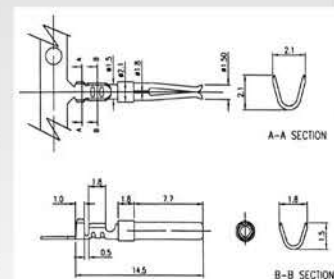

#### FEMALE TERMINAL:

5222-0.5K (500pcs/Reel)  
5222-10K (10000pcs/Reel)  
FOR AWG24-26

NOTE: P/N 5221-xxx/2024 & 5222-xxx/2024  
FOR AWG20~24