

## D-SUB. CONNECTOR RIGHT ANGLE TYPE WITH BOARDLOCKS (CONTACT EXTENSION: 7.2MM STANDARD)

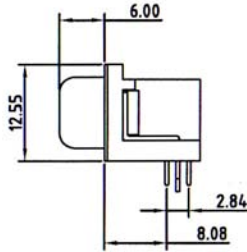

### 5259, 5261

No. of Contacts	Dimensions(mm)		
	A	B	C
09	16.92	24.99	30.81
15	25.25	33.32	39.14
25	38.96	47.04	53.04
37	55.42	63.50	69.32

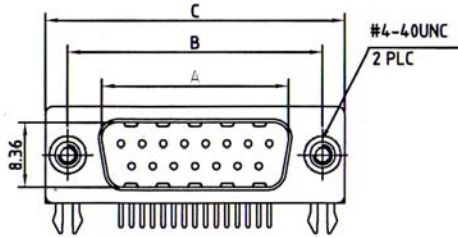
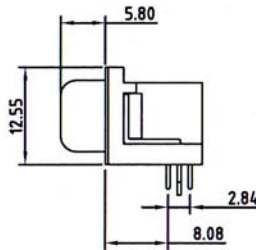
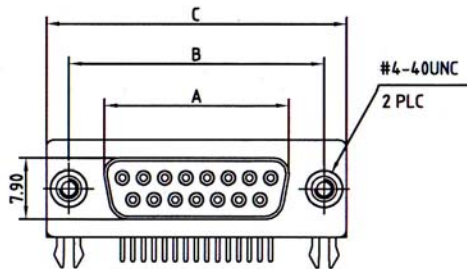

### 5260, 5262

No. of Contacts	Dimensions(mm)		
	A	B	C
09	16.33	24.99	30.81
15	24.66	33.32	39.14
25	38.38	47.04	53.04
37	54.84	63.50	69.32

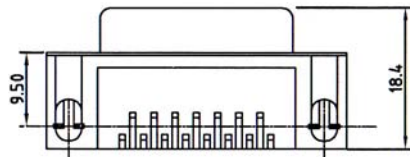

### SPECIFICATIONS

**Current Rating:** 3.0 Amperes  
**Contact Resistance:** 25mΩ Max.  
**Insulation Resistance:** 1000MΩ Min. at 500V  
**Dielectric Voltage:** 1000V at 1 Minute  
**Operating Temperature:** -55°C to +105°C

### MATERIALS

**Insulator:** PBT, UL94V-0 Rated  
**Contact:** Brass  
**Shell:** Brass, Steel  
**Contact Plating:** Gold Over Nickel Plated  
**Shell Plating:** Tin Over Copper Plated  
 \*RoHS & REACH compliant.

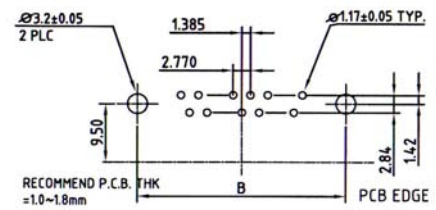

Recommended P.C. Board Layout

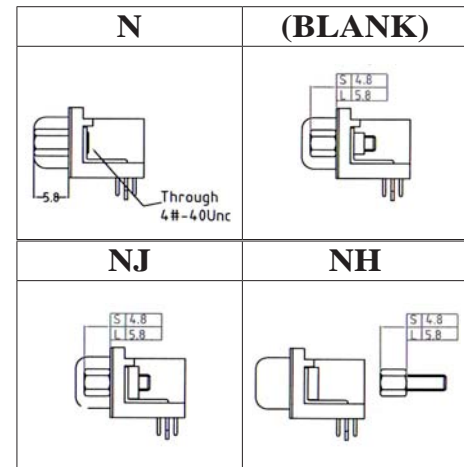

### ORDERING INFORMATION:

P/N 5 2  $\frac{XX}{1}$  -  $\frac{XX}{2}$  T B /  $\frac{XX}{3}$

#### 1. CONNECTOR TYPE:

- "59" MALE WITH SELECTIVE GOLD PLATED CONTACTS
- "60" FEMALE WITH SELECTIVE GOLD PLATED CONTACTS
- "61" MALE WITH FULL GOLD PLATED CONTACTS
- "62" FEMALE WITH FULL GOLD PLATED CONTACTS

#### 2. NO. OF CONTACTS:

09, 15, 25, 37

#### 3. MOUNTING OPTION:

- " " LOCKED SCREWS (4.8MM)
- "N" WITHOUT SCREWS (5.8MM)
- "NH" LOOSE SCREWS (4.8MM)
- "NJ" ASSEMBLED SCREWS (4.8MM)

## D-SUB. CONNECTOR RIGHT ANGLE TYPE WITHOUT BOARDLOCKS (CONTACT EXTENSION: 7.2MM)

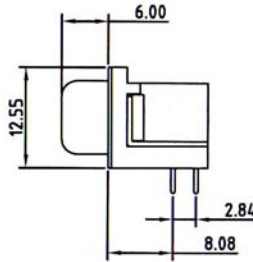
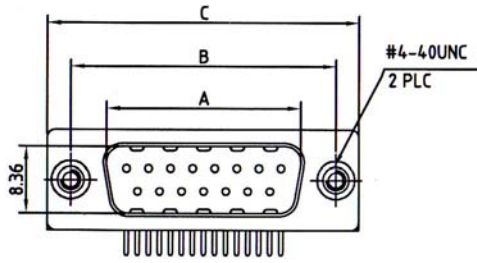

### 5259, 5261

No. of Contacts	Dimensions(mm)		
	A	B	C
09	16.92	24.99	30.81
15	25.25	33.32	39.14
25	38.96	47.04	53.04
37	55.42	63.50	69.32

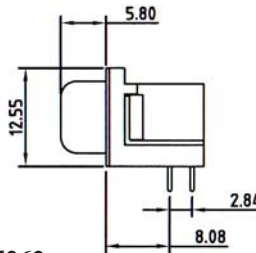
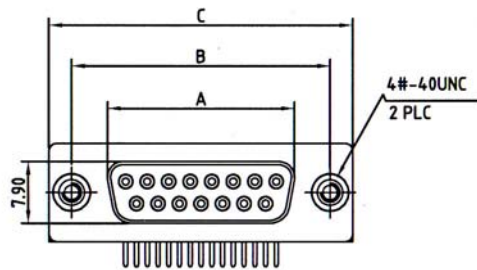
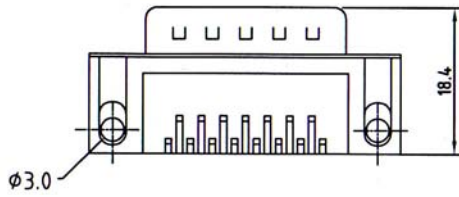

### 5260, 5262

No. of Contacts	Dimensions(mm)		
	A	B	C
09	16.33	24.99	30.81
15	24.66	33.32	39.14
25	38.38	47.04	53.04
37	54.84	63.50	69.32

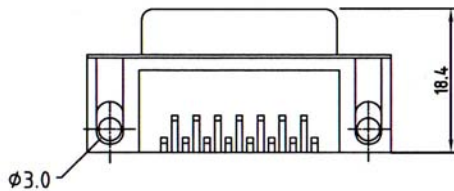

### SPECIFICATIONS

**Current Rating:** 3.0 Amperes  
**Contact Resistance:** 25mΩ Max.  
**Insulation Resistance:** 1000MΩ Min. at 500V  
**Dielectric Voltage:** 1000V at 1 Minute  
**Operating Temperature:** -55°C to +105°C

### MATERIALS

**Insulator:** PBT, UL94V-0 Rated  
**Contact:** Brass  
**Shell:** Brass, Steel  
**Contact Plating:** Gold Over Nickel Plated  
**Shell Plating:** Tin Over Copper Plated  
 \*RoHS & REACH compliant.

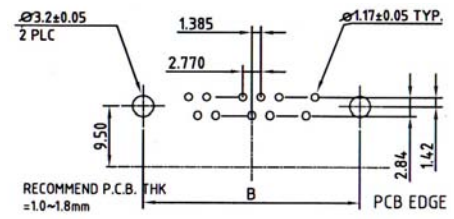

Recommended P.C. Board Layout

NB	NA
NK	NL

## ORDERING INFORMATION:

P/N 5 2  $\frac{XX}{1}$  -  $\frac{XX}{2}$  T B /  $\frac{XX}{3}$

### 1. CONNECTOR TYPE:

- "59" MALE WITH SELECTIVE GOLD PLATED CONTACTS
- "60" FEMALE WITH SELECTIVE GOLD PLATED CONTACTS
- "61" MALE WITH FULL GOLD PLATED CONTACTS
- "62" FEMALE WITH FULL GOLD PLATED CONTACTS

### 2. NO. OF CONTACTS:

09, 15, 25, 37

### 3. MOUNTING OPTION:

- "NA" LOCKED SCREWS (4.8MM)
- "NB" WITHOUT SCREWS (5.8MM)
- "NL" LOOSE SCREWS (4.8MM)
- "NK" ASSEMBLED SCREWS (4.8MM)