

D-SUB. CONNECTOR RIGHT ANGLE WITH BOARDLOCKS (CONTACT EXTENSION: 9.4MM STANDARD)

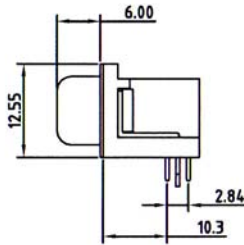

5273

No. of Contacts	Dimensions(mm)		
	A	B	C
09	16.92	24.99	30.81
15	25.25	33.32	39.14
25	38.96	47.04	53.04
37	55.42	63.50	69.32

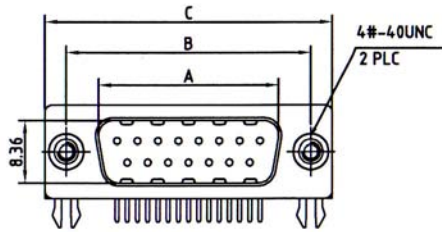
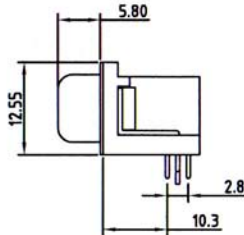
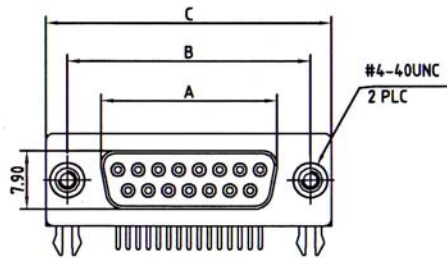
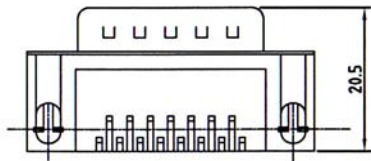

5274

No. of Contacts	Dimensions(mm)		
	A	B	C
09	16.33	24.99	30.81
15	24.66	33.32	39.14
25	38.38	47.04	53.04
37	54.84	63.50	69.32

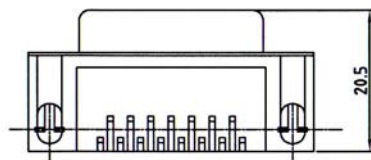

SPECIFICATIONS

Current Rating: 3.0 Amperes
 Contact Resistance: 25mΩ Max.
 Insulation Resistance: 1000MΩ Min. at 500V
 Dielectric Voltage: 1000V at 1 Minute
 Operating Temperature: -55°C to +105°C

MATERIALS

Insulator: PBT, UL94V-0 Rated
 Contact: Brass
 Shell: Brass, Steel
 Contact Plating: Gold Over Nickel Plated
 Shell Plating: Tin Over Copper Plated
 *RoHS & REACH compliant.

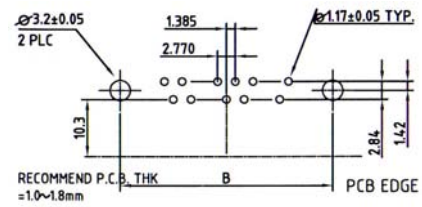

Recommended P.C. Board Layout

N	(BLANK)
NJ	NH

ORDERING INFORMATION:

P/N 5 2 $\frac{XX}{1}$ - $\frac{XX}{2}$ T B / $\frac{XX}{3}$

- CONNECTOR TYPE:
 "73" MALE
 "74" FEMALE
- NO. OF CONTACTS:
 09, 15, 25, 37
- MOUNTING OPTION:
 " " LOCKED SCREWS (4.8MM)
 "N" WITHOUT SCREWS (5.8MM)
 "NH" LOOSE SCREWS (4.8MM)
 "NJ" ASSEMBLED SCREWS (4.8MM)

D-SUB. CONNECTOR RIGHT ANGLE WITHOUT BOARDLOCKS (CONTACT EXTENSION: 9.4MM)

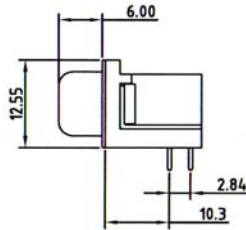
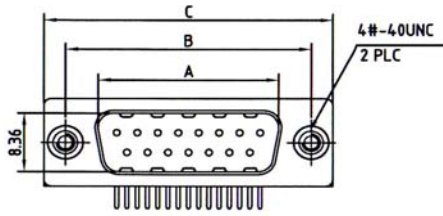

5273

No. of Contacts	Dimensions(mm)		
	A	B	C
09	16.92	24.99	30.81
15	25.25	33.32	39.14
25	38.96	47.04	53.04
37	55.42	63.50	69.32

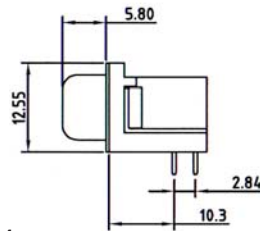
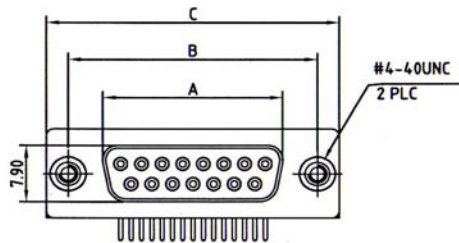

5274

No. of Contacts	Dimensions(mm)		
	A	B	C
09	16.33	24.99	30.81
15	24.66	33.32	39.14
25	38.38	47.04	53.04
37	54.84	63.50	69.32

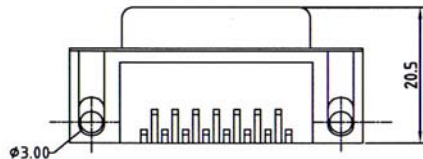

SPECIFICATIONS

Current Rating: 3.0 Amperes
Contact Resistance: 25mΩ Max.
Insulation Resistance: 1000MΩ Min. at 500V
Dielectric Voltage: 1000V at 1 Minute
Operating Temperature: -55°C to +105°C

MATERIALS

Insulator: PBT, UL94V-0 Rated
Contact: Brass
Shell: Brass, Steel
Contact Plating: Gold Over Nickel Plated
Shell Plating: Tin Over Copper Plated
***RoHS & REACH compliant.**

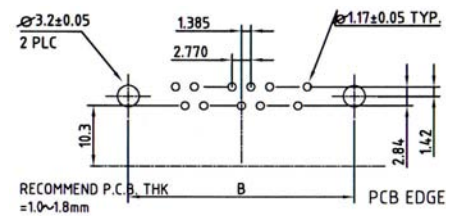

Recommended P.C. Board Layout

NB	NA
NK	NL

ORDERING INFORMATION:

P/N 5 2 $\frac{XX}{1}$ - $\frac{XX}{2}$ T B / $\frac{XX}{3}$

- CONNECTOR TYPE:
 "73" MALE
 "74" FEMALE
- NO. OF CONTACTS:
 09, 15, 25, 37
- MOUNTING OPTION:
 "NA" LOCKED SCREWS (4.8MM)
 "NB" WITHOUT SCREWS (5.8MM)
 "NL" LOOSE SCREWS (4.8MM)
 "NK" ASSEMBLED SCREWS (4.8MM)

D-SUB. RIGHT ANGLE CONNECTOR WITH 2 THROUGH HOLES (CONTACT EXTENSION=9.4MM)

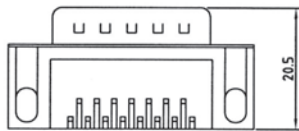
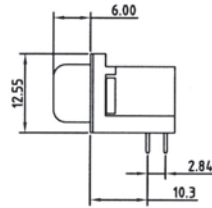
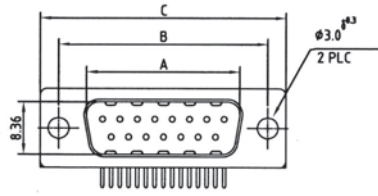

5273

No. of Contacts	Dimensions(mm)		
	A	B	C
09	16.92	24.99	30.81
15	25.25	33.32	39.14
25	38.96	47.04	53.04
37	55.42	63.50	69.32

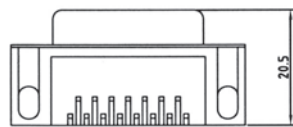
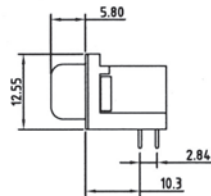
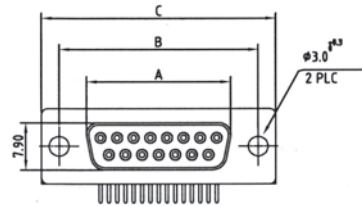

5274

No. of Contacts	Dimensions(mm)		
	A	B	C
09	16.33	24.99	30.81
15	24.66	33.32	39.14
25	38.38	47.04	53.04
37	54.83	63.50	69.32

SPECIFICATIONS

Current Rating: 3.0 Amperes
Contact Resistance: 30mΩ Max.
Insulation Resistance: 1000MΩ Min. at 500V
Dielectric Voltage: 1000V at 1 Minute
Operating Temperature: -55°C to +105°C

MATERIALS

Insulator: PBT
Contact: Copper Alloy
Shell: SPCC
Z-Piece: Copper Alloy
Rivet: Copper Alloy or Zinc
***RoHS & REACH compliant.**

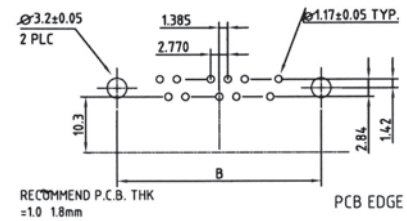

Recommended P.C.Board Layout

ORDERING INFORMATION:

P/N 52 $\frac{XX}{1}$ - $\frac{XX}{2}$ T B 2 H O

- CONNECTOR TYPE:
"73" MALE
"74" FEMALE
- NO. OF CONTACTS:
09, 15, 25, 37