

## SIDE ENTRY MODULAR PCB JACK 4P+6P+8P+10P PROFILE=11.50MM (UNSHIELDED)

### SPECIFICATIONS

**Insulation Resistance:** 500MΩ Min.  
**Contact Resistance:** 20mΩ Max.  
**Rating Current:** 1.5A Max.  
**Rating Voltage:** 120V AC.  
**Dielectric Voltage:** 1000 Vrms 60 Sec. Min.  
**Temperature Range:** -40°C / +85°C  
**Durability:** 500 Mating cycles Min.

### MATERIALS

**Housing:** PBT Glass Filled (UL 94V-0)  
**Soldering Temperature:** 235°C  
**Color:** Black  
**Spring Wire:** Phosphor Bronze  
 Gold plating Over Nickel  
**All materials must be RoHS compliant.**

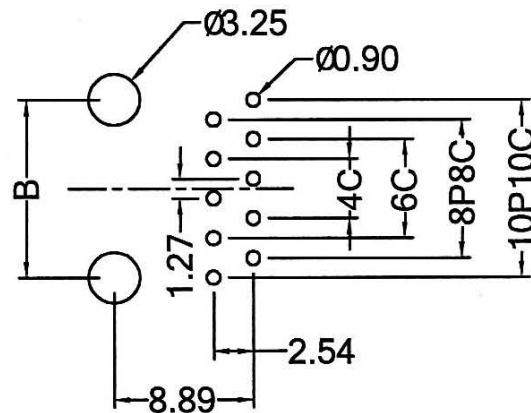
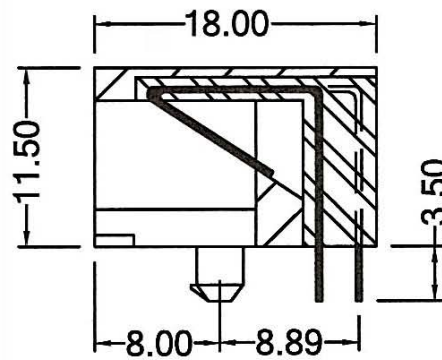
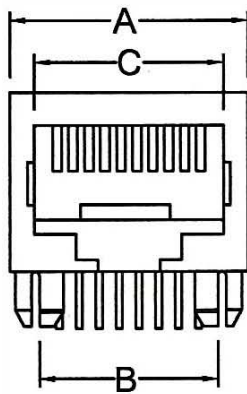

Recommended P.C. Board Layout  
(TOP VIEW)

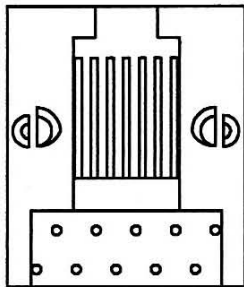

No. of Positions	No. of Contacts	A	B	C
4P	4C	11.20	7.62	7.80
6P	2C/4C/6C	13.20	10.16	10.00
8P	8C	15.20	11.43	12.00
10P	10C	15.20	11.43	12.00

### ORDERING INFORMATION:

P/N M J L G -  $\frac{x x x B}{T 2}$

#### 1. NO. OF POSITIONS & CONTACTS:

"66" 6P6C  
 "64" 6P4C  
 "88" 8P8C  
 "84" 8P4C  
 "00" 10P10C  
 "08" 10P8C  
 "44" 4P4C

#### 2. CONTACT FINISH:

"A" 6 MICROINCH GOLD  
 "B" 15 MICROINCH GOLD  
 "C" 30 MICROINCH GOLD  
 "D" 50 MICROINCH GOLD