

## SIDE ENTRY MULTI-PORT MODULAR PCB JACK 6P PROFILE=12.50MM (UNSHIELDED)

### SPECIFICATIONS

**Insulation Resistance:** 500MΩ Min.  
**Contact Resistance:** 20mΩ Max.  
**Rating Current:** 1.5A Max.  
**Rating Voltage:** 120V AC.  
**Dielectric Voltage:** 1000 Vrms 60 Sec. Min.  
**Temperature Range:** -40°C / +85°C  
**Durability:** 500 Mating cycles Min.

### MATERIALS

**Housing:** PBT Glass Filled (UL 94V-0)  
**Soldering Temperature:** 235°C  
**Color:** Black  
**Spring Wire:** Phosphor Bronze  
 Gold plating Over Nickel  
**All materials must be RoHS compliant.**

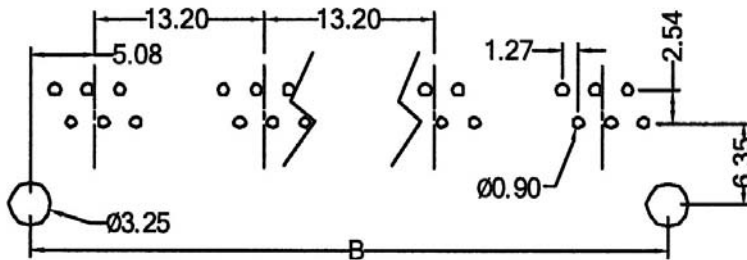
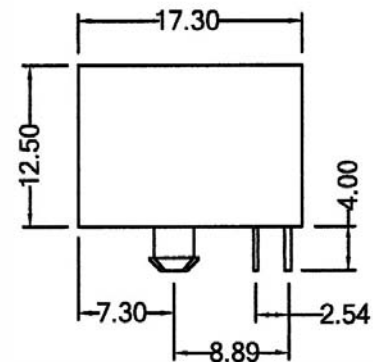
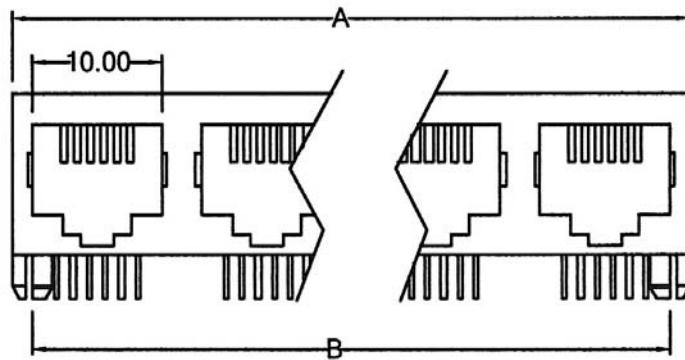

Recommended P.C. Board Layout  
(TOP VIEW)

Ports	A	B
02	26.40	23.36
03	39.60	36.56
04	52.00	49.76
05	66.00	62.96
06	79.20	76.16
07	92.40	89.36
08	105.60	102.56

### ORDERING INFORMATION:

P/N M J 4 L -  $\frac{x}{1} \frac{x}{2} \frac{x}{3} B \frac{x}{3}$

- NO. OF POSITIONS & CONTACTS:  
 "66" 6P6C  
 "64" 6P4C
- CONTACT FINISH:  
 "A" 6 MICROINCH GOLD  
 "B" 15 MICROINCH GOLD  
 "C" 30 MICROINCH GOLD  
 "D" 50 MICROINCH GOLD
- NO. OF PORTS:  
 02, 03, 04, 05, 06, 07, 08